

# HEADED BARS

Beat reinforcement congestion with Headed Bars

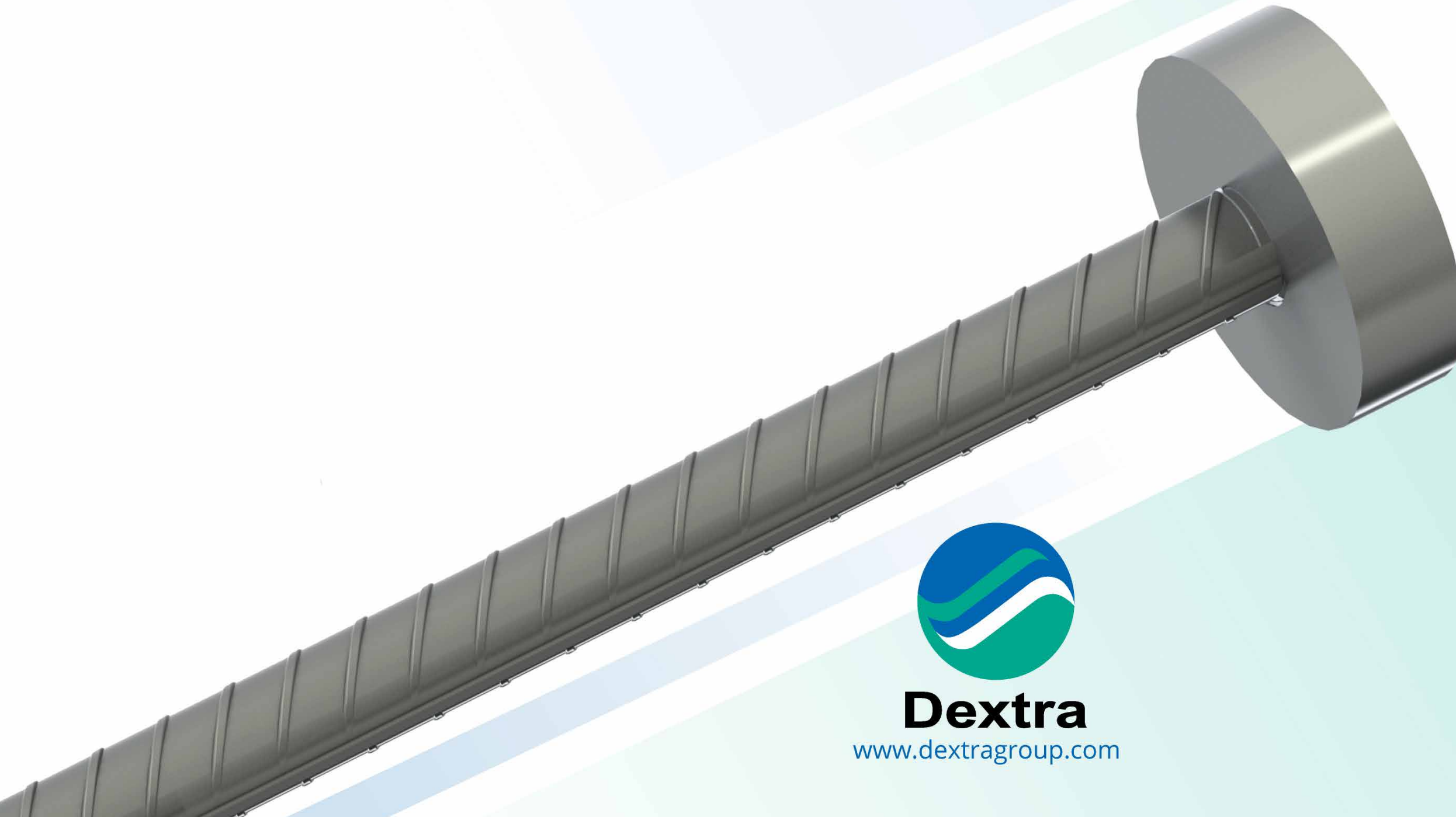

**Dextra**

[www.dextragroup.com](http://www.dextragroup.com)

## Product features

---

Headed Bars are mechanical anchorages where an anchor plate is fixed at the end of a threaded rebar. Headed Bars act as a substitute for development length and hook bars.

## Design benefits

---

- Reduced rebar congestion and steel/concrete ratio.
- Improved structure and greater buildability.
- Suitable with sequence of concrete pours.
- Suitable for seismic design.
- Compatible with bended bars to suit certain shapes.
- Come in two sizes to fit ACI / Eurocode requirements.

## Construction site benefits

---

- Fast to install: reduced labor and crane time.
- Head can be screwed/unscrewed to adjust if needed.
- Improved concrete compaction and surface quality (reduction of honeycombing).

## Fabricators benefits

---

Headed Bars are compatible with all Dextra threaded systems. On Bartec, Fortec, Rolltec, the anchor plate is fixed on an A-type threaded rebar. For Griptec, the anchors fit onto a male sleeve.

- No extra equipment is required.
- Same productivity as a regular A-thread (Bartec/Fortec/Rolltec) or male sleeve swaging (Griptec).
- For all bar sizes from Ø 10 to 50mm (ASTM #3 to #18).
- Globally certified solution.

## Globally certified solution

Country & Organization	Griptec		Bartec		Fortec		Rolltec	
	Small	Large	Small	Large	Small	Large	Small	Large
France (AFCAB)	12-40	12-40			12-40	12-40		
Poland (ITB)					12-40			
Romania (Procema)			12-40	12-40	12-40	12-40		
Russia (MTC)			12-40	12-40				
UK (CARES)	16-40	12-40*						
USA (IAPMO)			#4-#11				#4-#11	

\*For 40mm, only bolted headed bar is certified.

# Thread systems



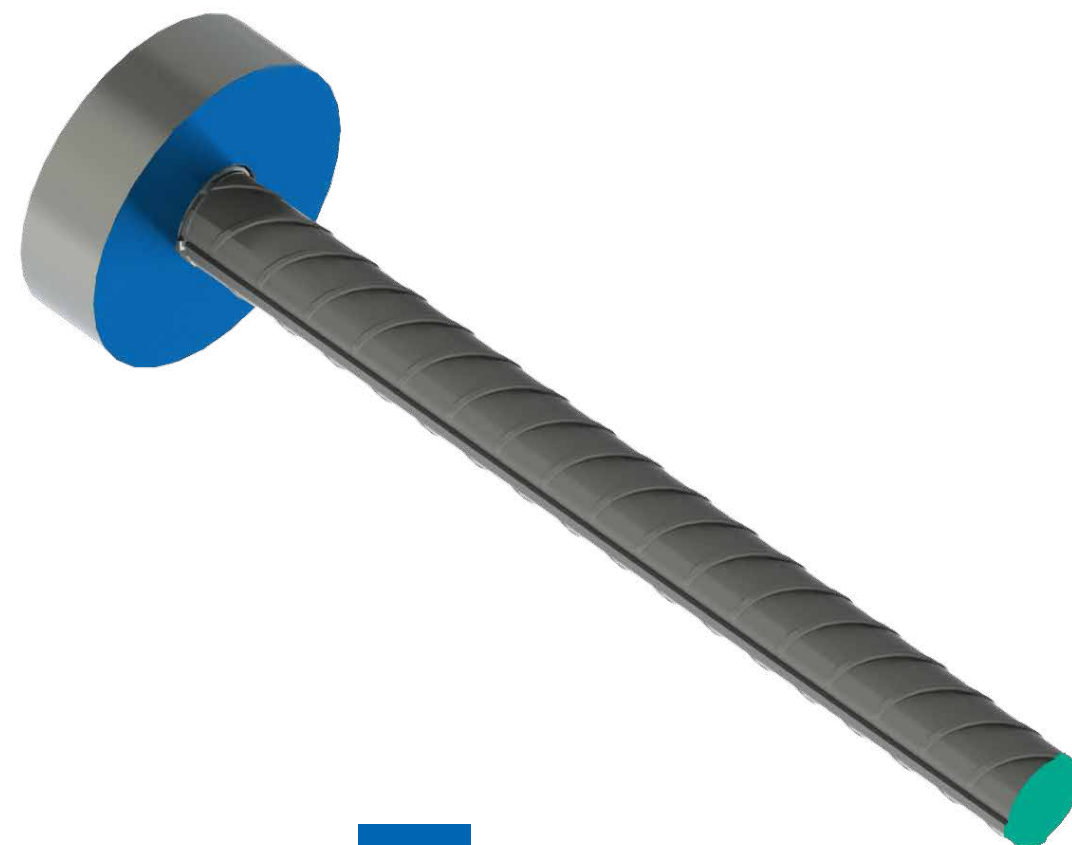

## Sizes

- ACI = Deep embedment = Small (Surface ratio > 4A)
- Eurocodes = Shallow embedment = Large (Surface ratio > 9A)



Compatible with all Dextra threaded systems worldwide.  
For Headed Bar systems without threads, please consult us.

**Surface ratio =**

-  Net bearing area
-  Nominal bar cross section area



# Applications

Beam ends & cantilever elements

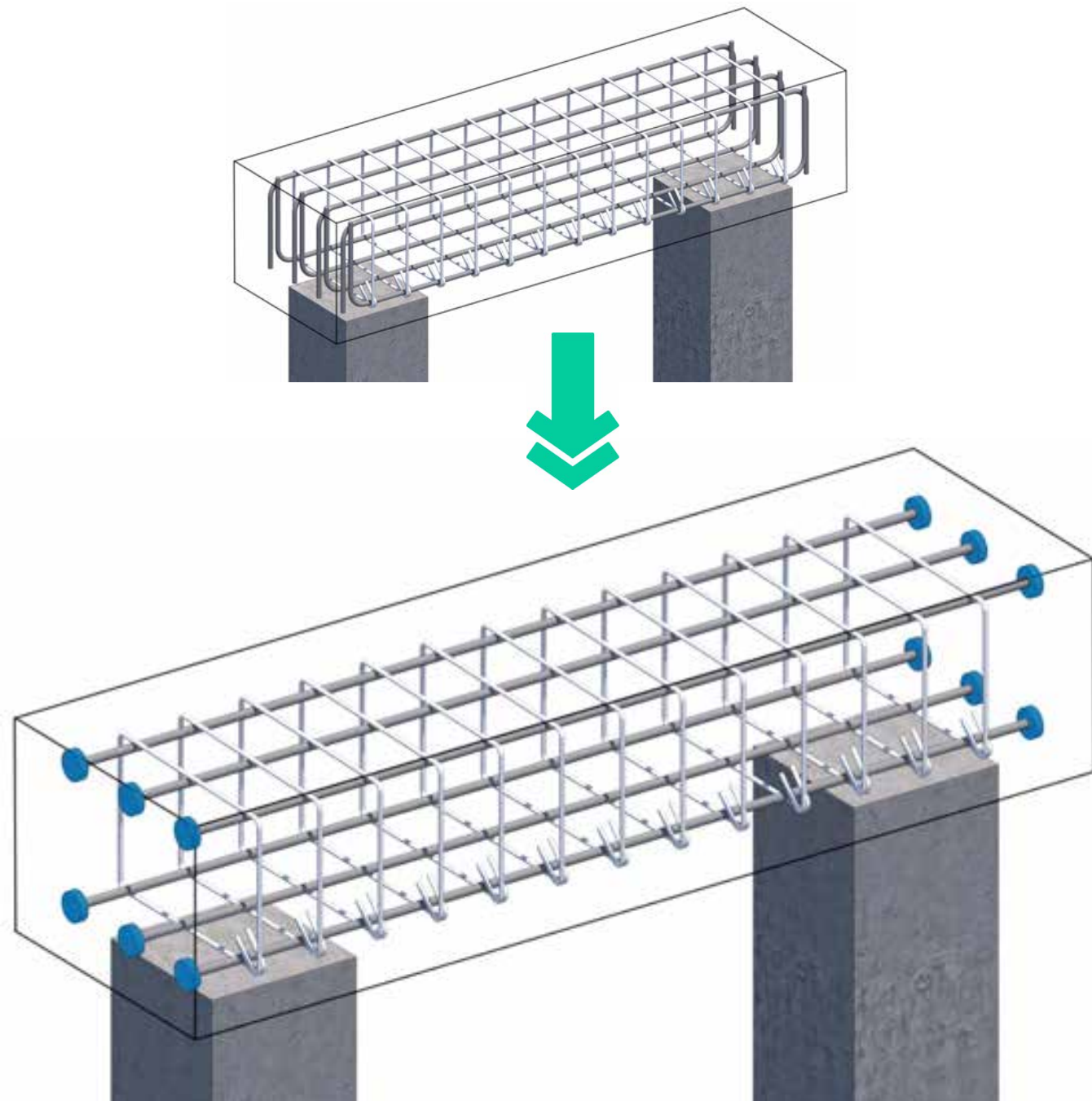

Corners

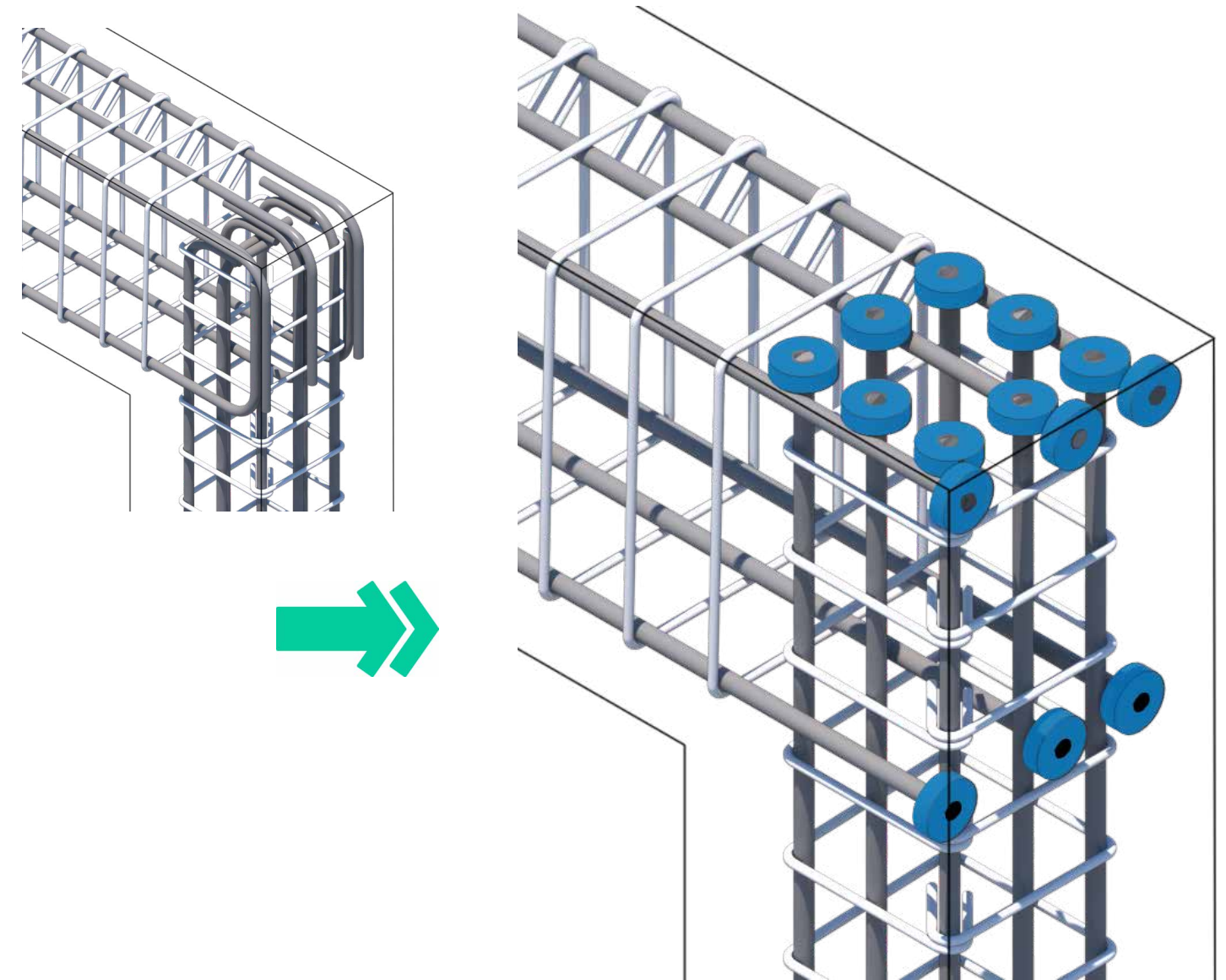

# Applications

Alternative to 90° hooks:  
Pile caps, column tops

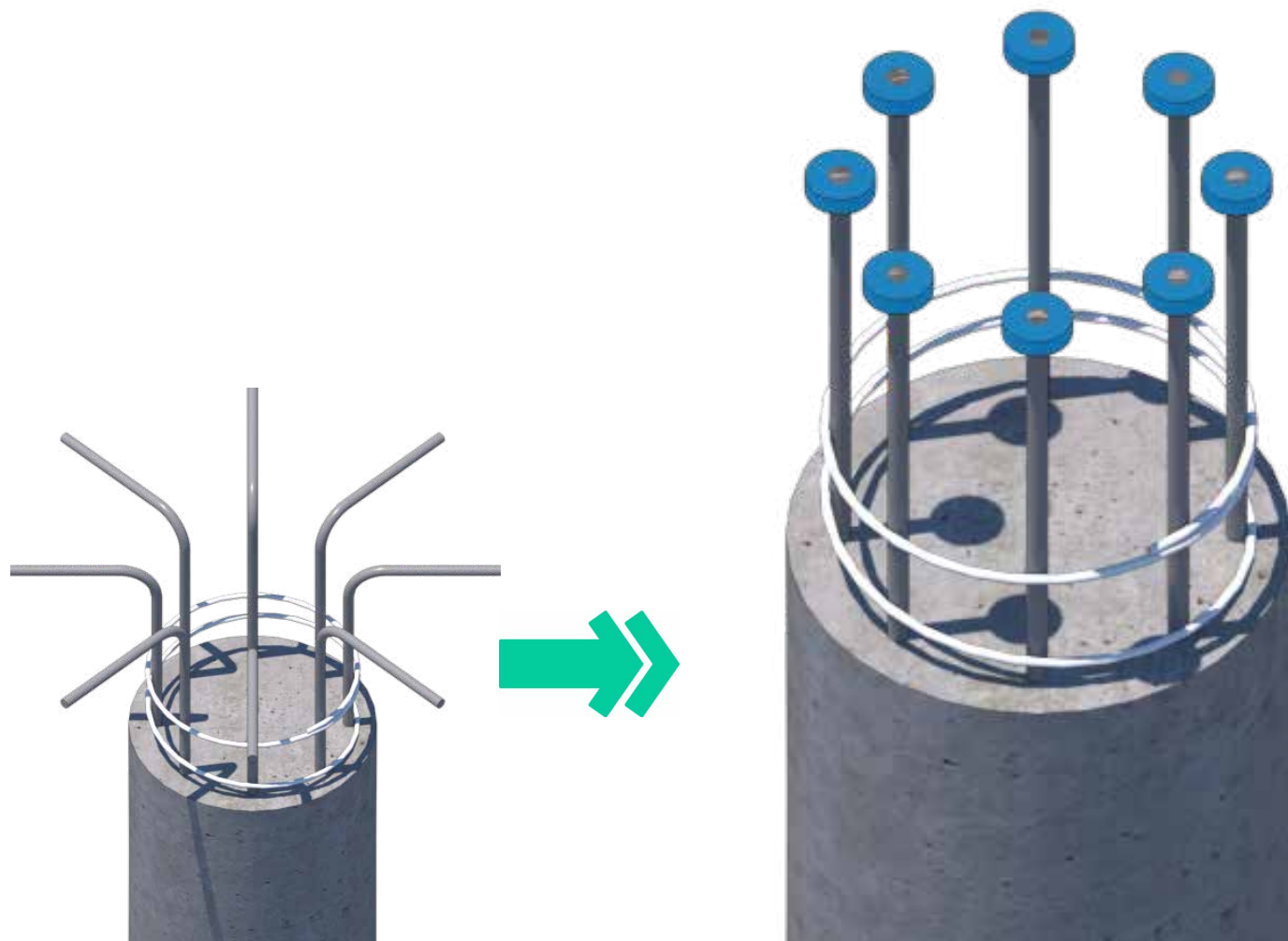

Alternative to 180° hooks:  
Slabs and wall shear links

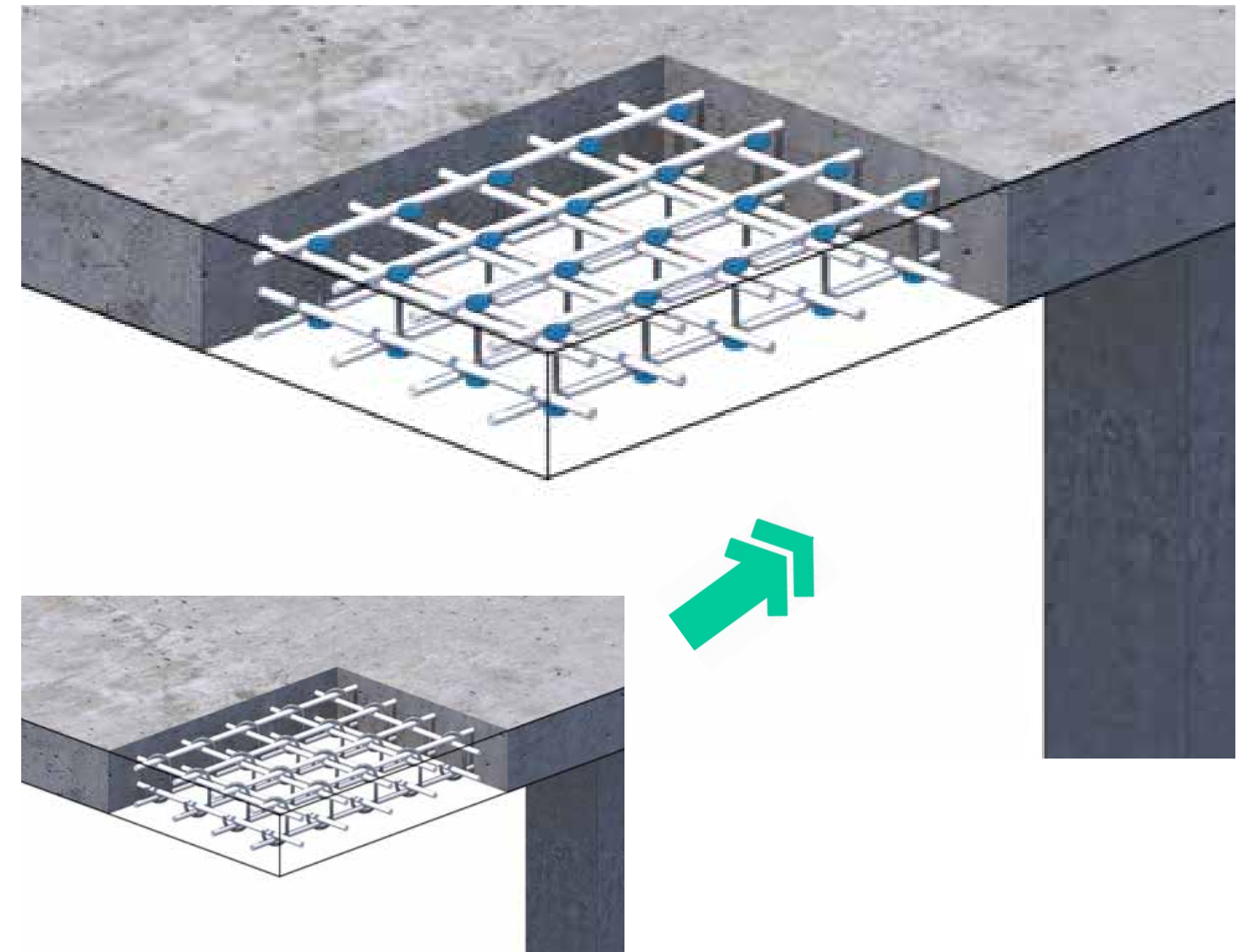



# Applications

Punching shear applications

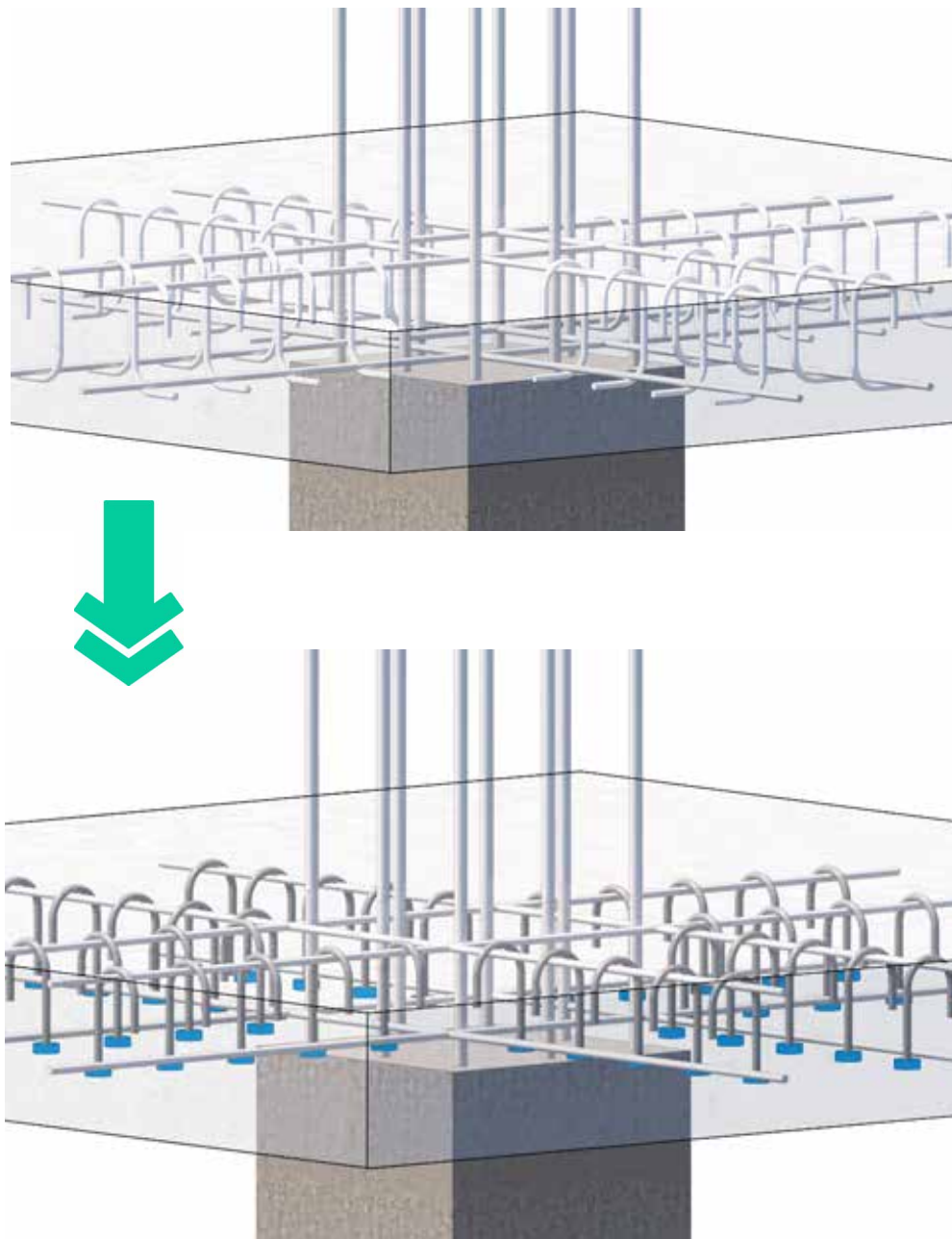

Substitutes long development length

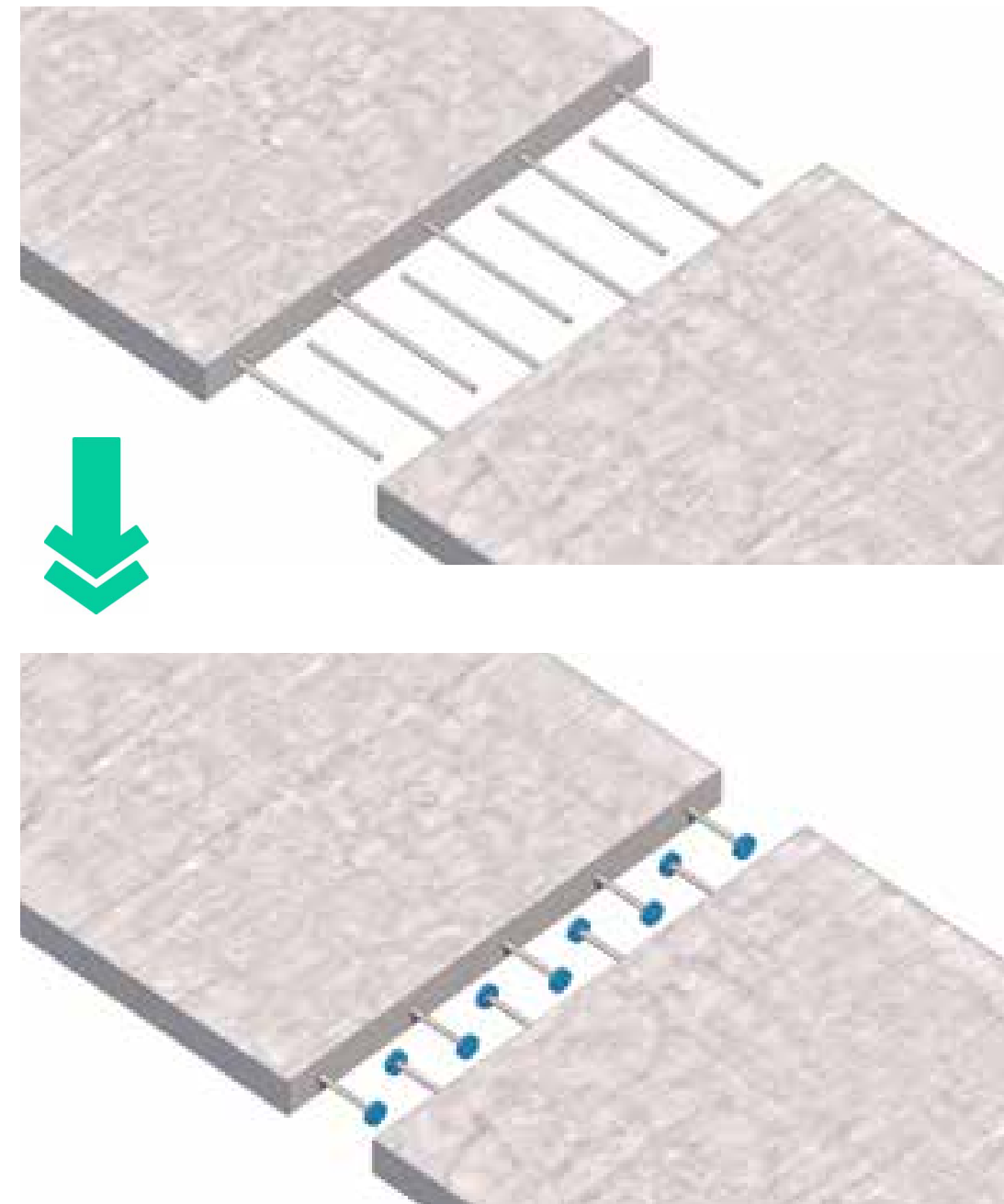



## Project References

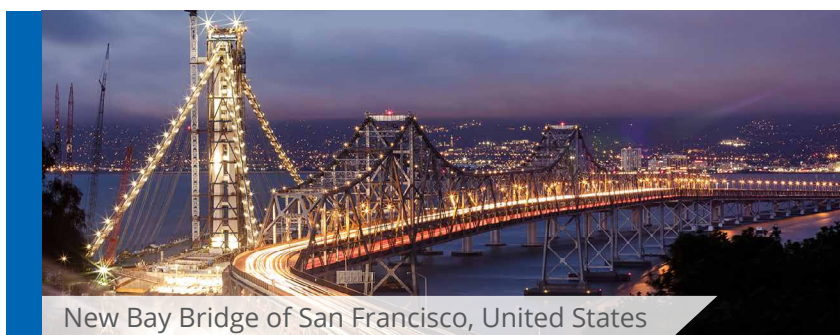

New Bay Bridge of San Francisco, United States



Icon Siam Complex, Thailand



RAPID Petrochemical Complex, Malaysia

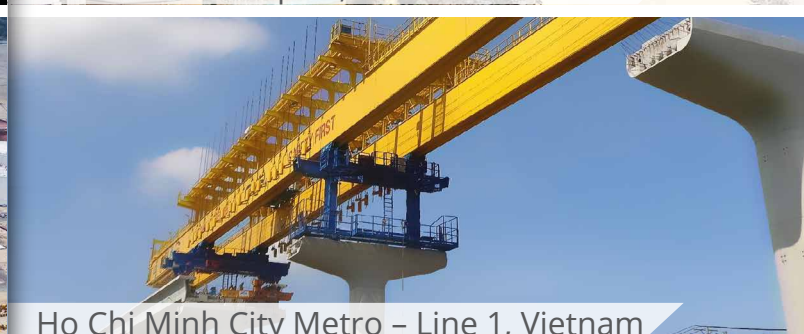

Ho Chi Minh City Metro - Line 1, Vietnam



Mecca Mataf Expansion, Saudi Arabia

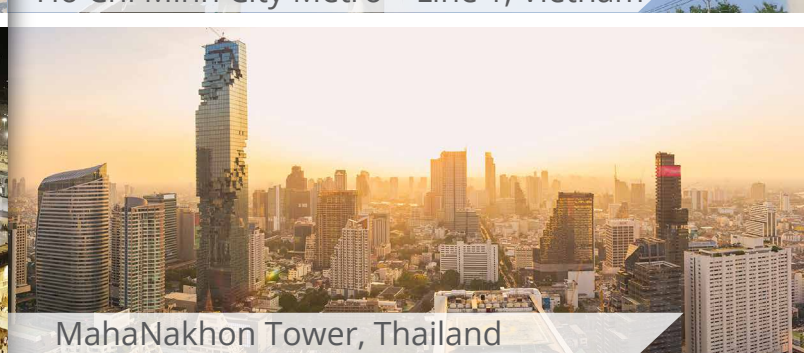

MahaNakhon Tower, Thailand

## Resources



Brochure



Certification



Case study



Webpage

## Compatible with



GRIPTEC



BARTEC II FORTEC



ROITEC

## Connect with us



www.dextragroup.com







Commercial presence  
in more than  
**55** countries



**Dextra**

[www.dextragroup.com/contact](http://www.dextragroup.com/contact)

**Main offices** (click on the address to see more information)

**HEADQUARTERS THAILAND**  
Dextra Manufacturing Co., Ltd.  
Tel: (66) 2 021 3800

**CHINA**  
Dextra Building Products (Guangdong) Co., Ltd.  
Tel: (86) 20 2261 9901

**HONG KONG**  
Dextra Pacific Ltd.  
Tel: (852) 2511 8236

**EUROPE**  
Dextra Europe SARL.  
Tel: (33) 1 45 53 70 82

**MIDDLE EAST**  
Dextra Middle-East FZE  
Tel: (971) 4886 5620

**INDIA**  
Dextra India Pvt. Ltd.  
Tel: (91) 22 2839 2694

**NORTH AMERICA**  
Dextra America Inc.  
Tel: (1) 206 742 6020

**LATIN AMERICA**  
Dextra Latam  
Tel: (507) 831 1442

**SOUTH AMERICA**  
Dextra do Brasil  
Tel: (55) 119 7577 8112